

ROOSEVELT HIGH SCHOOL LIBRARY SPACE ASSESSMENT & REVISION

Dana West, MLIS 2020

PROJECT GOAL

Envision possibilities for reorganizing the fixtures and collections in order to make the Roosevelt library a more dynamic space for the school community.

POTENTIAL IMPACTS

Increased library use, Greater campus unity
Readiness for a future as a 1:1 school

CHALLENGES



Large immovable shelves impede flexible use of space.



Bookcase built behind accessibility ramp.



Unused security gates block access to displays.



Study carrels and desktop PCs unnecessary with 1:1 laptops.

CURRENT LAYOUT

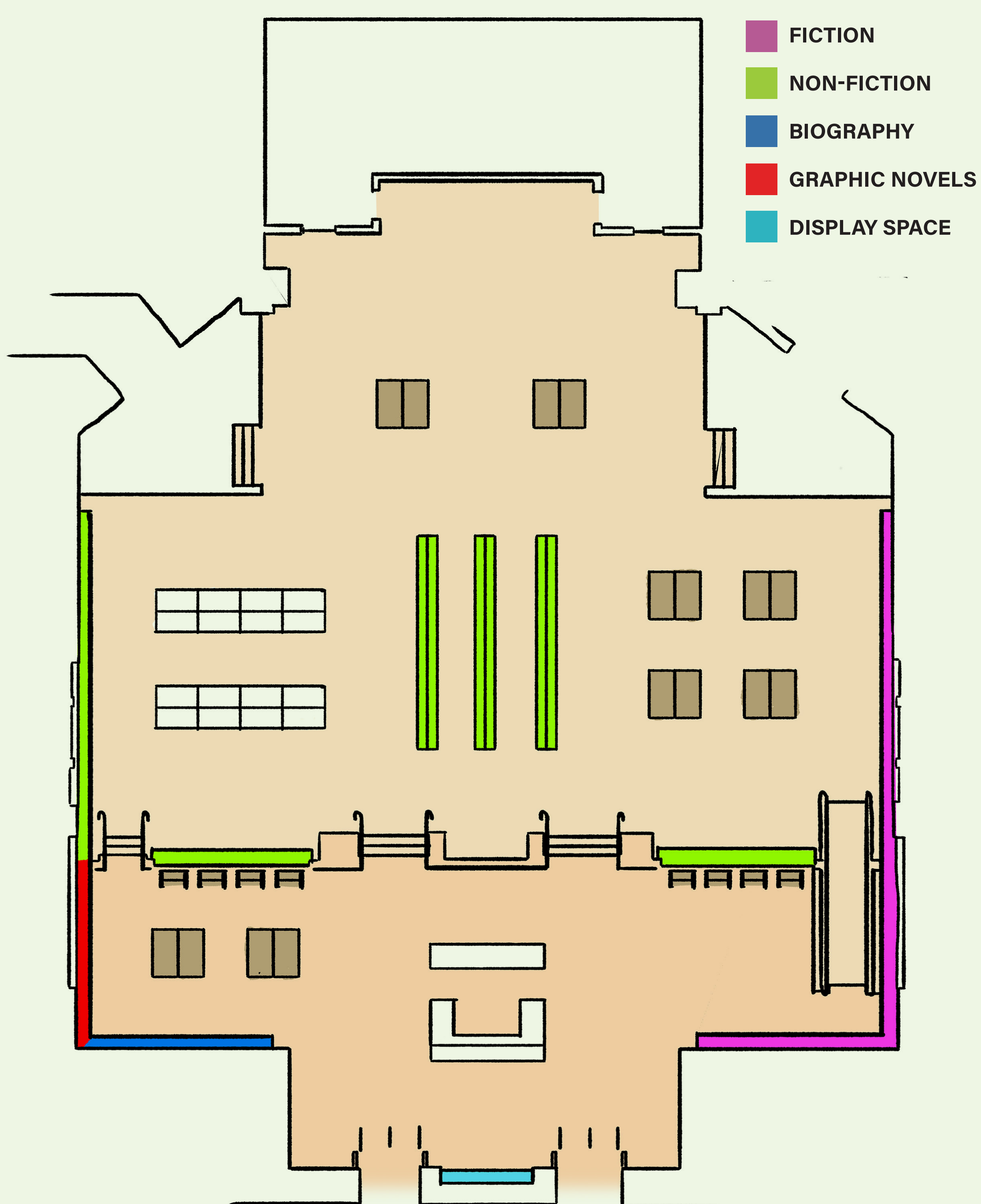

PROPOSED LAYOUT

Replace center banks of shelving with smaller units on casters, relocate fiction collection here.

This will make it much more browsable and accessible. ①

Remove the 8 study carrels.

They will no longer be necessary when RHS goes 1:1 with laptops in 2020-21. ②

Remove the security gates at the library entrance.

Currently unused, they make the entryway crowded and discourage access to the front display cabinet. ③

Maintain the wired PC lab for 2020-21 school year and collect data on its use in a 1:1 environment.

If used only minimally, remove those PCs and keep the tables for more flexible use. ④

Allocate funds to purchase an upgraded wireless microphone and sound system for better sound during large meetings and presentations. ⑤

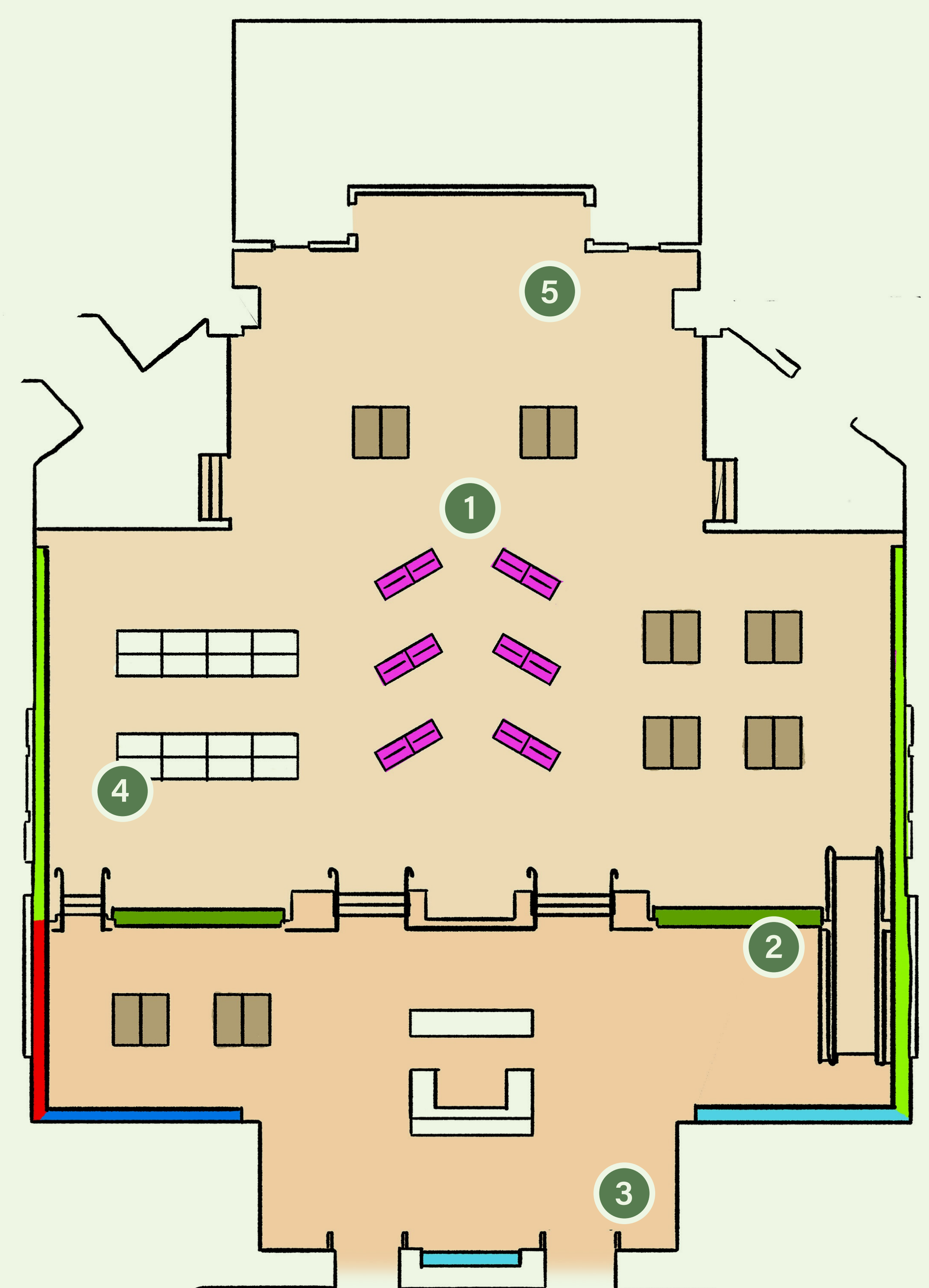

PROJECT TIMELINE & NEXT STEPS

COMPLETED DURING SCHOOL CLOSURE

- Calculate amount of new shelving needed
- Envision new ways to organize collection

POSTPONED DUE TO SCHOOL CLOSURE

- Administer surveys to students and staff
- Collect student/staff feedback on visuals of proposed new library layout
- Complete weeding

- Weeding
- Meeting with Principal

JAN

- Research
- Site visits

FEB

MAR

- Weeding
- Survey development